

Please take a moment to visit our website www.rainshower.com to view our complete line of shower, bath, yard, and garden dechlorinators and accessories. Rainshower is a proud subsidiary of Multipure.

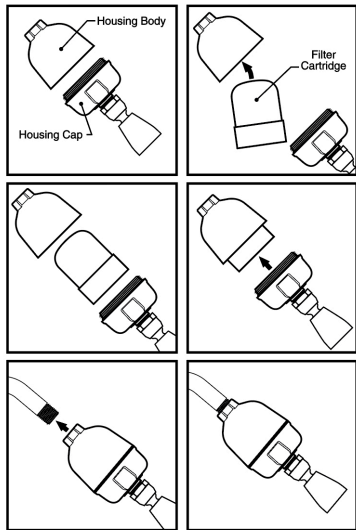

System tested and certified by Water Quality Association according to NSF/ANSI Standard 177 for the reduction of free available chlorine. While testing was performed under standard laboratory conditions, actual performance may vary.



RAINSHOWER

MODEL RCCQ-RS

Replacement Cartridge For Restore (CQ-1000) Shower Filter

INSTRUCTION GUIDE

Installing Your Filter Cartridge

1. Remove shower filter from shower arm. Unscrew cap from filter body, and remove used filter cartridge.
2. Re-position rubber "O" rings if they are dislodged. Place small O-ring in the filter housing body. Place large O-ring into groove in housing cap.
3. Place filter cartridge into housing body. Screw the top back into filter body. **Hand tighten only.**
4. Reconnect filter to shower arm. **Hand tighten only.** Allow water to run through filter for 30 to 60 seconds before the first use.

When To Change Your Cartridge

The CQ-1000 shower filter should be replaced at approximately 6 to 9 months. Chlorine levels vary across the country. If you live in an area where the source water supply contains high levels of suspected solids or where scale buildup in pipes is excessive, you may experience a reduction in water flow. This may be an indication that you need to change the cartridge more frequently than the recommended 6 to 9 months.

Warranty Information

The filter cartridge is warranted for a period of 30 days from the date of purchase. The manufacturer will repair or replace any shower filter that fails to perform due to faulty material or workmanship. Items not covered under the warranty include: damage due to misuse, improper maintenance, improper installation, excessive water pressure or temperature, freezing or general misapplication of filter's use and purpose. There are no warranties expressed or implied, other than those stated herein. We are not liable in any way for the damage arising from the misuse or misapplication of the product.

Notice On Limitations

This filter is designed for use on potable systems only. Do not allow to freeze. Do not use any type of sequestering agent ahead of the media. Its effectiveness will be reduced when used on high iron content municipal water systems that use chemicals such as polyphosphates.

Manufactured by:
Rainshower
7251 Cathedral Rock Dr.,
Las Vegas, NV 89128
702.483.4410